

## Gaskets

DN250 - DN2400

Stock no. 98044

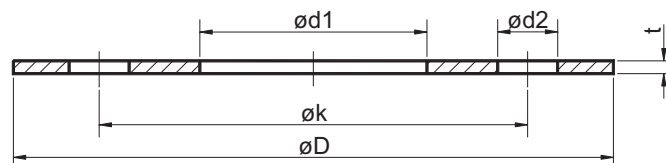

Stock No.	ND	Gasket			Bore			Weight [kg]
		øD [mm]	ød1 [mm]	t [mm]	ød2 [mm]	øk [mm]	Number of bolt holes	
98044-50-0250	250	375	276	2	18	335	12	0,17
98044-50-0300	300	440	327	2	22	395	12	0,22
98044-50-0350	350	490	359	2	22	445	12	0,29
98044-50-0400	400	540	410	2	22	495	16	0,32
98044-50-0450	450	595	461	2	22	550	16	0,37
98044-50-0500	500	645	512	2	22	600	20	0,40
98044-50-0550	550	703	563	2	22	650	20	0,46
98044-50-0600	600	754	614	2	22	700	20	0,50
98044-50-0650	650	805	665	2	22	750	20	0,54
98044-50-0700	700	856	716	2	22	800	24	0,58
98044-50-0750	750	907	767	2	22	860	24	0,62
98044-50-0800	800	958	818	2	22	900	24	0,66
98044-50-0850	850	1010	870	2	22	950	28	0,70
98044-50-0900	900	1060	920	2	22	1010	28	0,74
98044-50-0950	950	1110	970	2	22	1060	28	0,78

### Description:

2 mm graphite gasket  
Dimensions according to DIN 86044.

### Material: Grafoseal

- Tolerance of ød1:  
>200 ≤ 400 mm: +1  
> 400 mm: +1.5

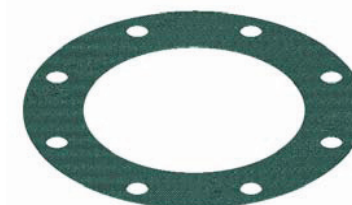

## Gaskets

DN250 - DN2400

Stock no. 98044

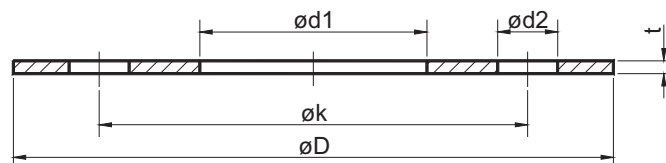

Stock No.	ND	Gasket			Bore			Weight [kg]
		øD [mm]	ød1 [mm]	t [mm]	ød2 [mm]	øk [mm]	Number of bolt holes	
98044-50-1000	1000	1162	1022	2	22	1110	32	0,81
98044-50-1050	1050	1216	1076	2	22	1160	32	0,85
98044-50-1100	1100	1266	1126	2	22	1210	32	0,89
98044-50-1200	1200	1366	1226	2	22	1310	36	0,97
98044-50-1300	1300	1466	1326	2	22	1410	40	1,00
98044-50-1400	1400	1566	1426	2	22	1510	40	1,07
98044-50-1500	1500	1666	1526	2	22	1610	44	1,14
98044-50-1600	1600	1766	1626	2	22	1710	48	1,21
98044-50-1700	1700	1866	1726	2	22	1810	48	1,29
98044-50-1800	1800	1966	1826	2	22	1910	52	1,36
98044-50-1900	1900	2066	1926	2	22	2010	56	1,43
98044-50-2000	2000	2166	2026	2	22	2110	56	1,50
98044-50-2100	2100	2266	2126	2	22	2210	60	1,57
98044-50-2200	2200	2366	2226	2	22	2310	64	1,64
98044-50-2300	2300	2466	2326	2	22	2410	64	1,72
98044-50-2400	2400	2566	2426	2	22	2510	68	1,79

### Description:

2 mm graphite gasket  
Dimensions according to DIN 86044.

### Material: Grafoseal

- Tolerance of ød1:  
>200 ≤ 400 mm: +1  
> 400 mm: +1.5

